



REVISIONS

△	REVISED DETAIL	RZ 08/23/07
△	ADDED ANCHOR BOLTS	RZ 07/26/07
△	RELEASED FOR FIELD	RZ 07/24/07

NO. OF HOLES	DATE	BY
STEEL	06/25/07	R.Z.
NO. OF HOLES	DATE	BY
STEEL	06/25/07	R.Z.

DESIGNED BY	DATE
R.Z.	06/22/07
CHECKED BY	DATE
R.Z.	06/25/07

COVEDALE ELEM. SCHOOL
CINCINNATI, OHIO
ANCHOR BOLT PLAN

ARCHITECT	KZF DESIGN
ENGINEER	KZF DESIGN
CONTRACTOR	TRICON

JOB ORDER NO.	M5474
DRAWING NO.	AB1
REV.	

APPROVAL	
SHOP	
FIELD	
REF. DWG.	S101.S102.S103

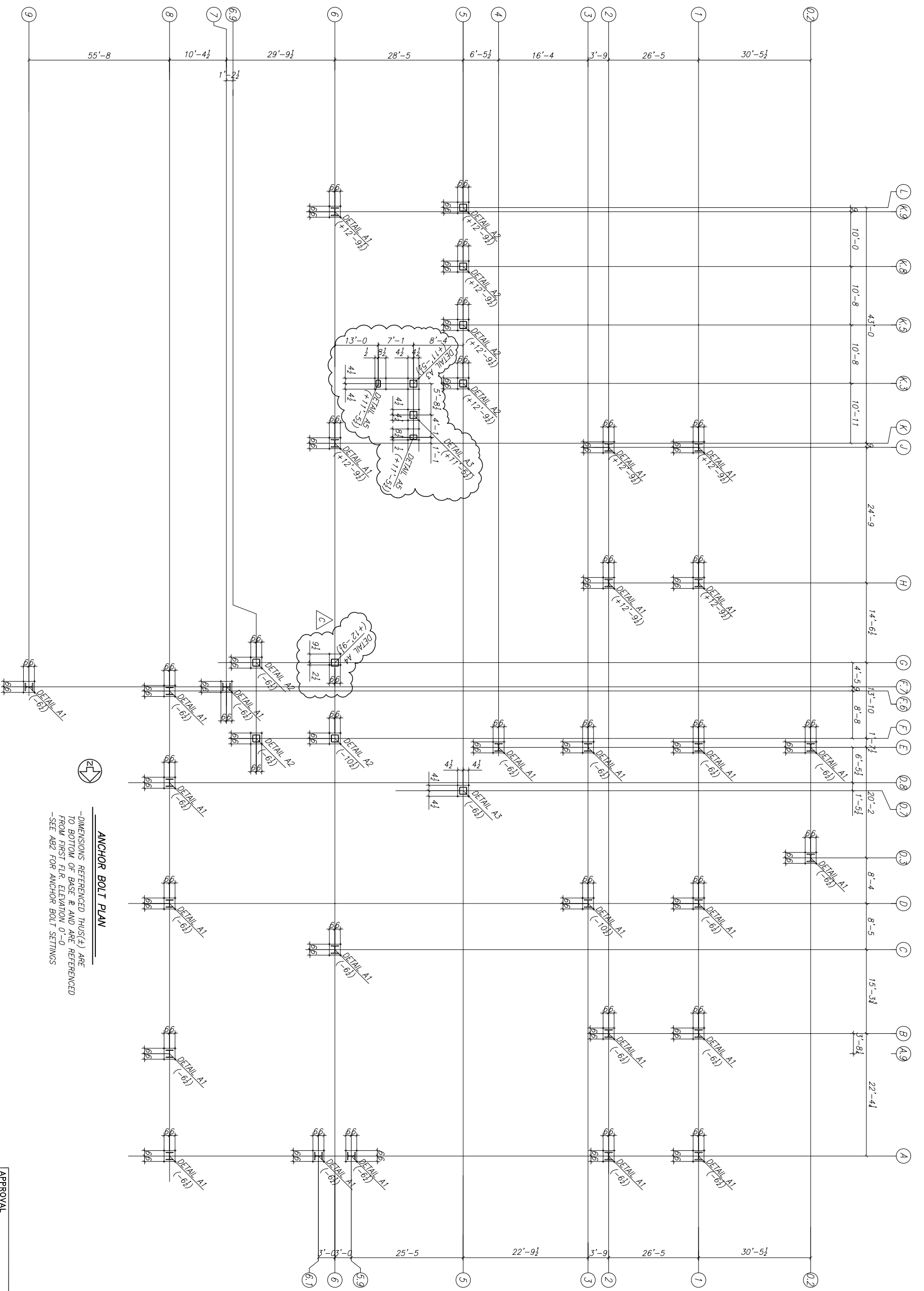

ANCHOR BOLT PLAN

-DIMENSIONS REFERENCED THUS(±) ARE TO BOTTOM OF BASE W AND ARE REFERENCED FROM FIRST FLR. ELEVATION 0'-0

-SEE AB2 FOR ANCHOR BOLT SETTINGS